

FIRE & THEFT DIGITAL SAFE FS28

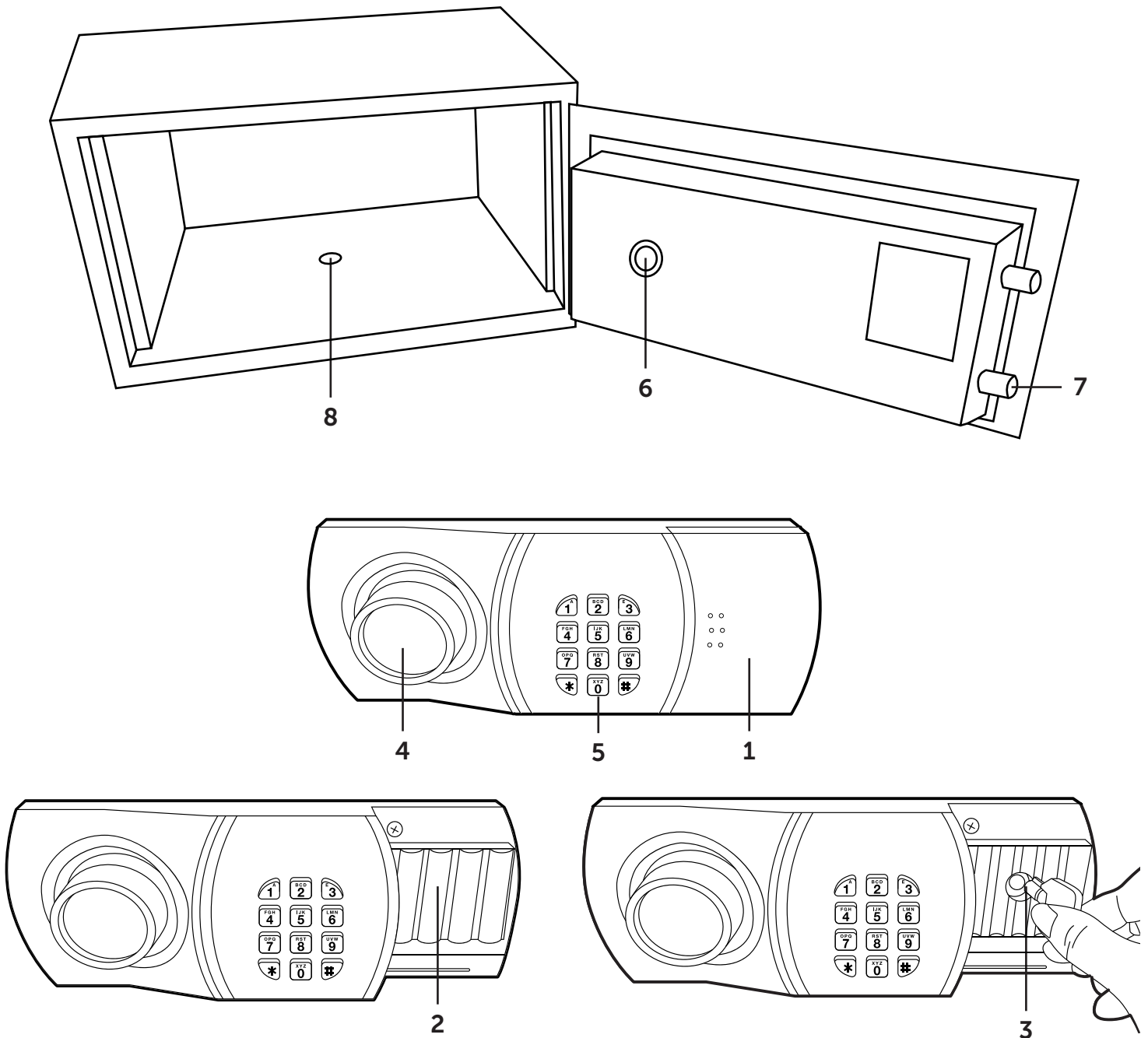

1. Battery & Emergency Key Cover
2. Battery Compartment
3. Emergency Key Hole
4. Knob Handle

5. Digital Key Pad
6. Reset Button
7. Locking Bolts
8. Mounting Hole

⚠ WARNING: DO NOT STORE YOUR KEYS INSIDE THE SAFE

For enquiries call (03) 9786 0055

PROGRAMMING YOUR SAFE

Batteries

1. Remove the battery/emergency key cover.
2. Insert 4 x AA batteries into the battery compartment.
When replacing batteries in the future it is best to use heavy duty alkaline AA batteries.
3. Replace battery/emergency key cover.

Note: When you replace the batteries, you will also need to re-program your user code

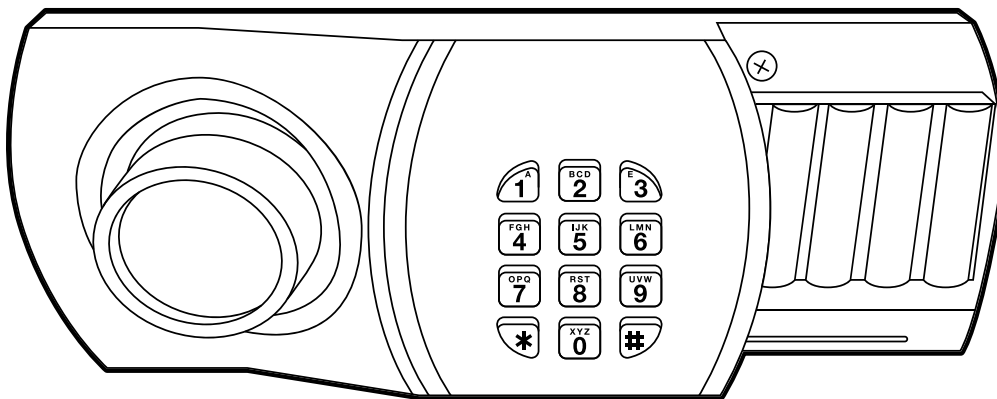

Program User Code

This safe comes programmed with a preset factory code – * 1 2 3 4 5 6 #.

For security purposes you will need to change this to your own personal code by following the steps below:

1. Enter * 1 2 3 4 5 6 and press # button. '1 2 3 4 5 6 - GOOD - OPEN" will appear in blue on the FND screen and a beep will sound. Turn the knob handle clockwise to open the safe.
2. With the door open press the * button and press the reset button located on the back of the door within 5 seconds and release the button as soon as the beep is heard, USE-01 will appear on the FND Screen
3. Input your new user code (3 – 8 digits) followed by the # key (within 5 seconds)

Caution! Before closing the door, please check your new code by using the opening procedure while the door is still open.

If you wish to change your code again, redo the steps above.

 **WARNING: DO NOT STORE YOUR KEYS INSIDE THE SAFE**

USING YOUR SAFE

You will now be able to unlock your safe using your own user code

Open Safe with User Code

1. Enter * followed by your 3 – 8 digit user code
2. Confirm code by pressing the # key. If the code entered is correctly, the blue LED will turn on.
3. Turn Knob Handle Clockwise and open the safe

(If the code is entered incorrectly consecutively more than 3 times the safe will automatically lock for 30 seconds)

Emergency Keys

If the code is forgotten or the batteries go flat access can be gained using the emergency keys.

1. Remove battery/emergency key cover
2. Remove batteries
3. Insert emergency key (push in) and turn anti clockwise a quarter turn
4. Turn the knob handle clockwise to open the safe.

Note: Replace batteries at the first sign they are becoming weak

The emergency keys are provided for:

- Initial entry to the safe.
- A means of access if the batteries go flat.
- A means of access if you forget your user code.

They should not be used for everyday access. Responsibility will not be taken if the user misplaces the emergency keys. Store these keys in a safe place but **NOT** inside the safe!

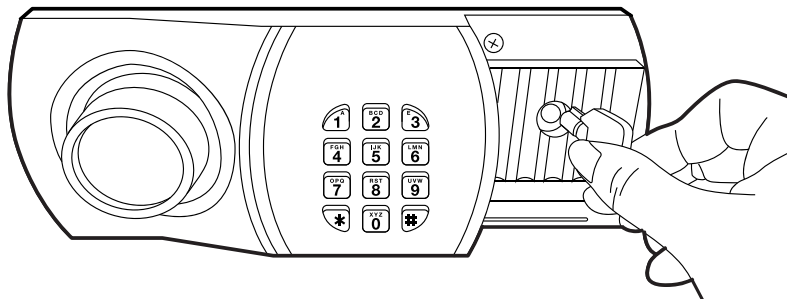

Low Battery

If the batteries become low L-Batt will appear on the screen alerting you to change the batteries.

Note: If the door does not open even before the low battery display, the current may be weak, and all four batteries must be replaced with new ones.

 **WARNING: DO NOT STORE YOUR KEYS INSIDE THE SAFE**

INSTALLING YOUR SAFE

Before Installing to Floor Surface remove feet at bottom of safe by unscrewing.

Concrete Installation

For Installation into concrete surfaces, use the provided masonry bolts.

1. Install your safe in a location that is secure and sturdy.
2. Drill a hole for a 12mm masonry bolt in the desired location.
3. Insert the masonry bolt through the hole in the safe and into the concrete.
4. Tighten masonry bolt using a socket or spanner.

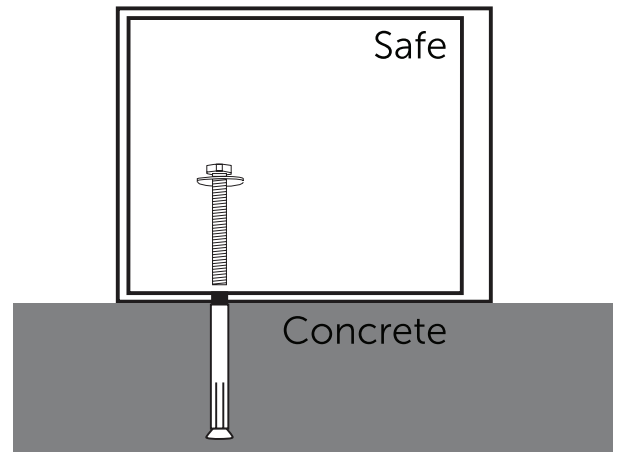

Timber Installation

For installation onto a timber surface, use coach screws (not included).

1. Install your safe in a location that is secure and sturdy.
2. Drill a pilot hole in the desired location(s).
3. Insert the coach screw through the hole in the safe and into the timber.
4. Tighten coach screws using a socket or spanner.

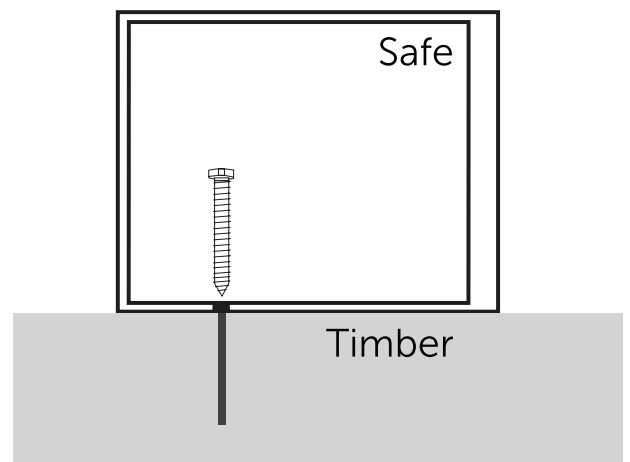

Note: All safes should be bolted down to ensure the best possible security.

 **WARNING: DO NOT STORE YOUR KEYS INSIDE THE SAFE**

FIRE RESISTANCE

Your new safe is rated fire resistant for 30 minutes. In the event of fire your safe will get hot. Your new safe comes with a fire/heat resistant pouch. This pouch has been designed to further protect polymer banknotes from heat. Whilst the ignition point of polymer banknotes is higher than that of paper banknotes, they can under certain circumstances melt and stick together in a fire. Putting polymer banknotes in this pouch inside your new safe gives added fire and heat protection.

MAINTENANCE

- If you wish to clean your safe, use a damp cloth. Do not use liquid or sprayers.
- Never try to dismantle the product by yourself.
- Keep a record of your passcode in a safe secure space. Not inside the safe.

Note: A safe is an aid only in reducing theft, it must form only a part of a range of security measures used. Sandleford Holdings Pty Ltd will not accept or be held responsible for any loss or damage caused in the event of theft or unauthorised use.

SUPPORT

For enquiries contact Sandleford Customer Service.



Monday – Friday
9am – 5pm (Excluding Public Holidays)
(03) 9786 0055



or Email us at
sales@sandleford.com.au

 **WARNING: DO NOT STORE YOUR KEYS INSIDE THE SAFE**